



Architectural Casework

Product Workbook



BASE CABINETS – 30", 34", 36" HIGH counter/desk/work surface height

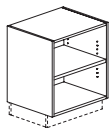

(W) 12 15 16 18 21 24 30 32 36 42 48
 (H) 24½ 28½ 30½
 (D) 19⅞ 23⅞
100100 Base Cabinet – Open

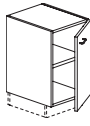

(W) 12 15 16 18 21 24
 (H) 24½ 28½ 30½
 (D) 20⅞ 24
100101 Base Cabinet – Single Door

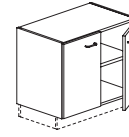

(W) 24 30 32 36 42 48
 (H) 24½ 28½ 30½
 (D) 20⅞ 24
100102 Base Cabinet – Double Door



(W) 12 15 16 18 21 24
 (H) 28½ 30½
 (D) 20⅞ 24
100211 Drawer Storage Base – Single Door

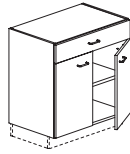

(W) 24 30 32
 (H) 28½ 30½
 (D) 20⅞ 24
100212 Drawer Storage Base – Double Door

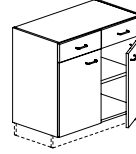

(W) 36 42 48
 (H) 28½ 30½
 (D) 20⅞ 24
100221 Drawer Storage Base – Double Drawer

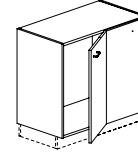

(W) 36
 (H) 28½ 30½
 (D) 20⅞ 24
100176 Corner Base Cabinet

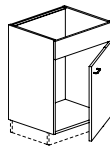

(W) 24
 (H) 30½
 (D) 20⅞ 24
100151 Sink Base w/False Front – Single Door

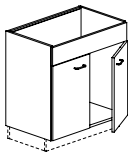

(W) 24 30 32 36 42 48
 (H) 30½
 (D) 20⅞ 24
100152 Sink Base w/False Front – Double Door

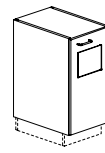

(W) 16
 (H) 30½
 (D) 20⅞ 24
100103 Trash Door Base Cabinet – Single Door

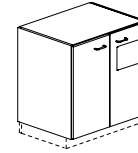

(W) 32
 (H) 30½
 (D) 20⅞ 24
100104 Trash Door Base Cabinet – Double Door

BASE CABINETS – 30" HIGH desk/work surface height

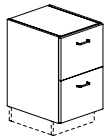

12" (W) 16 18 21
 12" (H) 24½
 (D) 20⅞ 24
100223 File Base Cabinet, 12-12

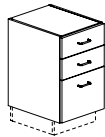

6" (W) 16 18 21
 6" 6" (H) 24½
 12" (D) 20⅞ 24
100230 Drawer File Base Cabinet, 6-6-12

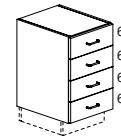

6" (W) 16 18 21
 6" 6" 6" (H) 24½
 6" (D) 20⅞ 24
100245 Drawer Base Cabinet, 6-6-6-6

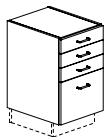

4" (W) 16
 4" 4" (H) 24½
 12" (D) 20⅞ 24
100240 Utility Drawer Base Cabinet, 4-4-4-12

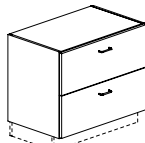

12" (W) 32
 12" (H) 24½
 (D) 20⅞ 24
100225 Lateral File Base Cabinet, 12-12

BASE CABINETS – 34" HIGH ADA counter height

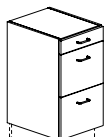

4" (W) 16 18 21
 12" 12" (H) 28½
 (D) 20⅞ 24
100231 Drawer File Base Cabinet, 4-12-12

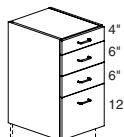

4" (W) 16 18 21 24
 6" 6" (H) 28½
 12" (D) 20⅞ 24
100241 Utility Drawer Base Cabinet, 4-6-6-12

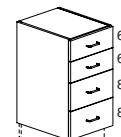

6" (W) 15 16 18 21
 6" 6" 8" (H) 28½
 8" (D) 20⅞ 24
100246 Drawer Base Cabinet, 6-6-8-8

BASE CABINETS – 36" HIGH counter height

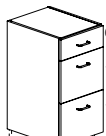

6" (W) 16 18 21 24
 12" 12" (H) 30½
 (D) 20⅞ 24
100232 Drawer File Base Cabinet, 6-12-12

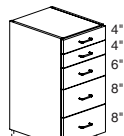

4" (W) 15 16 18
 4" 6" 8" (H) 30½
 8" (D) 20⅞ 24
100242 Utility Drawer Base Cabinet, 4-4-6-8-8

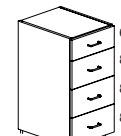

6" (W) 15 16 18 21 24 30 32
 8" 8" 8" (H) 30½
 (D) 20⅞ 24
100247 Drawer Base Cabinet, 6-8-8-8

WALL CABINETS – 18", 24", 30", 36", 40" HIGH doors project 1" below cabinet

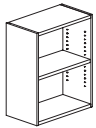

(W) 12 15 16 18 21 24 30 32 36 42 48
 (H) 18 24 30 36 40
 (D) 13 1/4

100300

Wall Cabinet – Open



(W) 12 15 16 18 21 24
 (H) 18 24 30 36 40
 (D) 14

100301

Wall Cabinet – Single Door

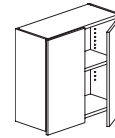

(W) 24 30 32 36 42 48
 (H) 18 24 30 36 40
 (D) 14

100302

Wall Cabinet – Double Door

WALL CABINETS – 36", 40" HIGH lateral organizers

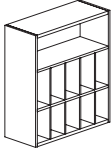

(W) 32
 (H) 36
 (D) 13 1/4

100335

Lateral Organizer Cabinet

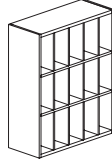

(W) 32
 (H) 40
 (D) 13 1/4

100336

Lateral Organizer Cabinet

WALL CABINETS – 36", 40" HIGH specialty cabinets

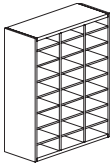

(W) 32 36
 (H) 36 40
 (D) 13 1/4

100341

Mail Storage Cabinet

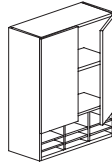

(W) 32
 (H) 36 40
 (D) 14

100355

Form Holder Cabinet – Double Door

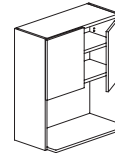

(W) 32
 (H) 36 40
 (D) 14

100360

Microwave Cabinet – Double Door

WALL CABINETS – prescription desks

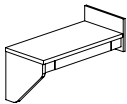

(W) 34
 (H) 29
 (D) 16

100290

Prescription Desk – Corner Mounted

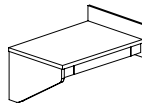

(W) 34
 (H) 29
 (D) 23

100291

Prescription Desk – Corner Mounted

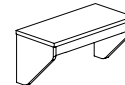

(W) 36
 (H) 29
 (D) 16

100292

Prescription Desk – Wall Mounted

STORAGE CABINETS – 61", 80" HIGH tall cabinets

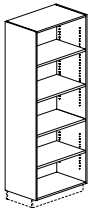

(W) 12 16 18 24 30 32 36 42 48
 (H) 61 80
 (D) 13 1/4 19 5/8 23 1/4

100400

Tall Storage Cabinet – Open

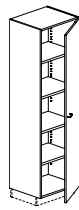

(W) 12 16 18 24
 (H) 61 80
 (D) 14 20 5/8 24

100401

Tall Storage Cabinet – Single Door

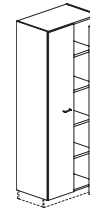

(W) 24 30 32 36 42 48
 (H) 61 80
 (D) 14 20 5/8 24

100402

Tall Storage Cabinet – Double Door

STORAGE CABINETS – 61", 80" HIGH wardrobe cabinet/lateral organizer

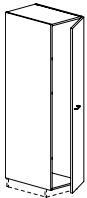

(W) 16
 (H) 61
 (D) 24

100411

Tall Wardrobe Cabinet – Single Door



(W) 32
 (H) 61
 (D) 24

100412

Tall Wardrobe Cabinet – Double Door

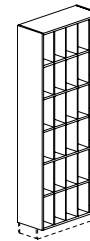

(W) 32
 (H) 80
 (D) 13 1/4

100430

Lateral Organizer Cabinet

STORAGE CABINETS – 71" HIGH lockers

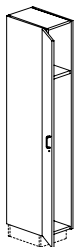

(W) 12
 (H) 71
 (D) 18

100500

Locker – Single Door

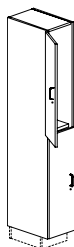

(W) 12
 (H) 71
 (D) 18

100505

Locker – Double Door

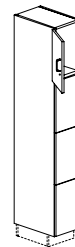

(W) 12
 (H) 71
 (D) 18

100506

Locker – Quadruple Door

LINAC CABINETS

Compatible with Varian and Siemens oncology systems

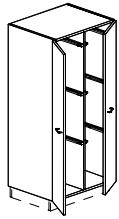

(W) 30
(H) 61
(D) 24

100420

Cone Storage Cabinet
(18³/₈"H applicator spacing)

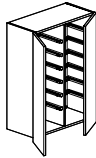

(W) 30
(H) 39³/₄
(D) 14

100370

Mold Storage Cabinet
(5¹/₈"H tray spacing)



(W) 16
(H) 27
(D) 6¹/₂

100374

Laser Cabinet
(field drill hole in door)

SPECIALTY CABINETRY AND ACCESSORIES

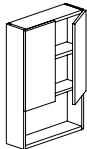

(W) 24
(H) 36
(D) 7

100357

Toilet Wall Cabinet
(24" doors)

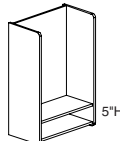

(W) 24¹/₂
(H) 36
(D) 13¹/₈

100371

Telephone Cabinet

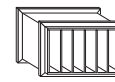

(W) 18³/₄
(H) 12
(D) 12

100373

Records Pass

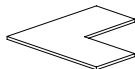

(W) 30
(H) 1
(D) 30

100375

Corner Open Shelf
(field cut per plan)

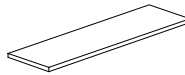

(W) 120
(H) 1
(D) 11³/₈ 15³/₈

100811

Open Shelving



(W) 24
(H) 15⁵/₈
(D) 10⁵/₈

100372

Wall Shelf



Scope mounting
bracket and
shelf by others

(W) 24
(H) 91
(D) 14

100410

Scope Cabinet

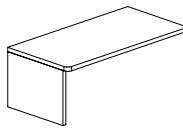

(W) 48
(H) 18
(D) 24

100900

Dressing Bench (reversible)



(W) 16
(H) 30¹/₂
(D) 23¹/₄

100178

X-Ray Base Cabinet

COMPONENTS



(W) 12 15 16 18 21 24 30 32 36 42 48

(H) 1

(D) 14 20 24

100800

Cabinet Shelf



500 - random

501 - alike

900500

Lock - Single Door/Drawer



502 - random

503 - alike

900502

Lock - Single Door/Drawer



(W) 1
(H) 40
(D) ³/₄

800101

Wall Scribe



(W) 4
(H) 40
(D) ³/₄

800102

Wall Scribe



(W) 1
(H) 24¹/₂ 30¹/₂ 96
(D) ³/₄

800103

Base/Tall Scribe

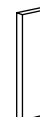

(W) 4
(H) 24¹/₂ 30¹/₂ 96
(D) ³/₄

800104

Base/Tall Scribe

PRODUCT CONFIGURATION OPTIONS

STANDARD FINISHES

Cabinet Color:

001-Antique White	003-Arctic White	012-American Cherry	017-Kensington Maple	019-Fine Oak
035-Opal Gray	045-Slate			

Front Color:

001-Antique White	003-Arctic White	012-American Cherry	017-Kensington Maple	019-Fine Oak
035-Opal Gray	045-Slate			

Base: (all bases are 4" high)

000-No Base

011-Base-Finished

012-Base-Unfinished

Ladder Base

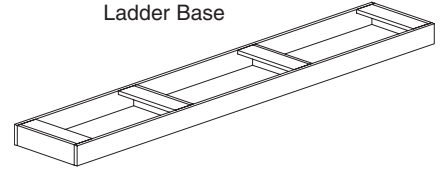
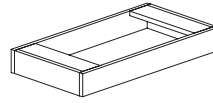
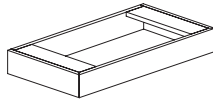

This unfinished continuous base is not a product option, and must be ordered separately.

Pull Option:

098 - No pull; no pull holes 099 - No pull; 96mm hole pattern

006 Strap	007 Trimline	008 Ellipse	009 Eyelid	011 Standard	012 Standard	013 Standard	014 Standard	015 Curved	016 Curved
Satin Chrome	Satin Chrome	Satin Chrome	Satin Chrome	Satin Chrome	Black	Antique White	Arctic White	Black	Pewter

Hinge Orientation:

Left Hinged

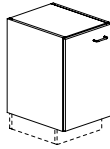

Right Hinged

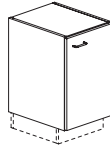

COUNTERTOPS STANDARD FINISHES



STYLE A – Countertop without Backsplash

1 1/2" particle board with high-pressure laminate surface and 1.4 mm PVC edging.

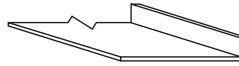

STYLE B – Countertop with Backsplash

1 1/2" particle board with high-pressure laminate surface and 1.4 mm PVC edging. 4" backsplash.



STYLE C – Countertop for Reception Ledge

1 1/2" particle board with high-pressure laminate surface and 1.4 mm PVC edging.

Countertop Color:

001-Antique White	003-Arctic White	012-American Cherry	017-Kensington Maple	019-Fine Oak
050-Wheat Fiber	060-Evening Tigris	061-Gray Tigris	062-Dove Morraine	063-Silicon Evolv
064-Gray Tranquility	065-Ochre Tempera			

Construction Details



MATERIALS

Core Materials

1. Particleboard up to 3/4-inch thick:
M3 Industrial Grade average 47-pound density.
2. Particleboard 1-inch thick or thicker:
M3 Industrial Grade average 45-pound density.
3. MDF 1/4-inch thick: Industrial Grade average 45-pound density.

Decorative Laminates

1. High-pressure decorative laminate Type GP28 vertical grade on drawer/doors fronts and specified exposed panels.
2. High-pressure decorative laminate Type GP48 horizontal grade on countertops.
3. Thermally fused melamine laminate on cabinet cases, drawer components and shelves.

Edging

1. 1.4mm PVC banding with eased radius on drawer/door fronts and countertops.
2. 0.5mm PVC banding on all other components.

CABINET HARDWARE

Hinges

1. Concealed 120-degree swing, six-way adjustable clip-on. Nickel-plated metal. Two hinges per door up to 40 inches, three hinges per door on tall cabinets. (*standard*)
2. Concealed 170-degree swing, six-way adjustable clip-on. Nickel-plated metal. Two hinges per door up to 40 inches, three hinges per door on tall cabinets. (*optional*)

Pulls

1. Steel, nickel-plated or powder coated in a variety of styles.

Slides

1. Zinc plated steel with steel roller ball bearings, side mounted, full extension on all drawers. Pencil drawers, box drawers and deep drawers are rated at 100-pound with full extension and designated file drawers are rated at 150-pound.

Drawer Systems

1. All designated file drawers have an integrated, metal hanging file system to allow for front-to-back or side-to-side filing.

Locks

1. Lock systems allow for all single or ganged locked drawers or individual single/double doors.

FABRICATION

1. Base cabinets are constructed of 3/4-inch thick M3 industrial grade particleboard. Wall cabinets are constructed with 3/4-inch thick M3 industrial grade particleboard sides and 1-inch thick M3 industrial grade particleboard top and bottom. Tops and bottoms are glued and doweled to cabinet sides and fixed internal dividers.
2. Cabinet fronts are 3/4-inch thick with vertical grade GP28 laminate on both sides.
3. Finished end panels are either vertical grade GP28 laminate or thermally fused melamine to match cabinet color, whichever is specified.
4. All exterior and interior surfaces are finished in thermally fused laminate and all internal parts are finished to match cabinet color.
5. Cabinet shelves are 1-inch thick thermally fused laminate and sealed completely with all sides edged.
6. Cabinet backs 1/4-inch thick laminated with thermally fused melamine to match cabinet finish, trapped in a 1/4-inch wide groove and stapled in place.
7. Drawer boxes are 5/8-inch thick laminate, 4-sided and finished in maple.
8. Base cabinets are edged on all sides including back edge. Base cabinets, except sink base, have a full sub top. Sink base units have an open top with steel supports in front and back concealed behind front panel.
9. Cabinet base may be ordered as finished or unfinished and attached. Cabinets can be ordered with no base in applications where a ladder base is appropriate.

WARRANTY

1. All Techline architectural cabinets and countertops come with a limited 5-year warranty to the original owner against defective material and workmanship.